



# YARD FORCE®

FOR LIFE ON THE GO

LW CVC1

GB

## 20V CORDLESS WET&DRY VACUUM CLEANER

Original Instructions

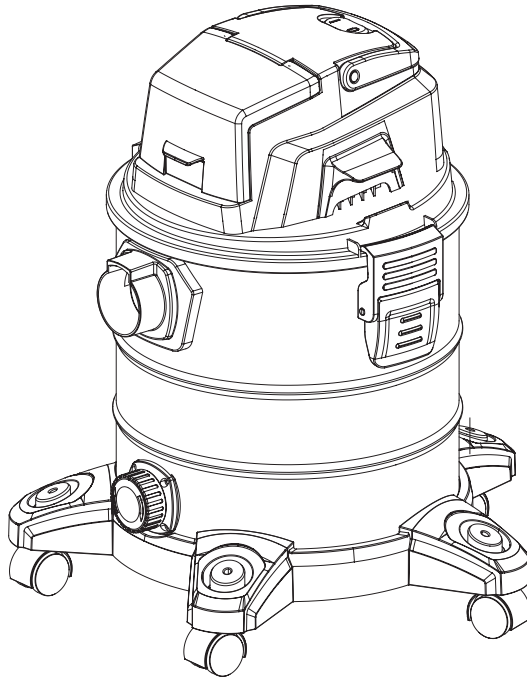

**BETRIEBSANLEITUNG AUFMERKSAM LESEN**



**Bewahren Sie alle Warnhinweise und Anleitungen zum  
Nachlesen auf.**

CE



UK  
CA

A

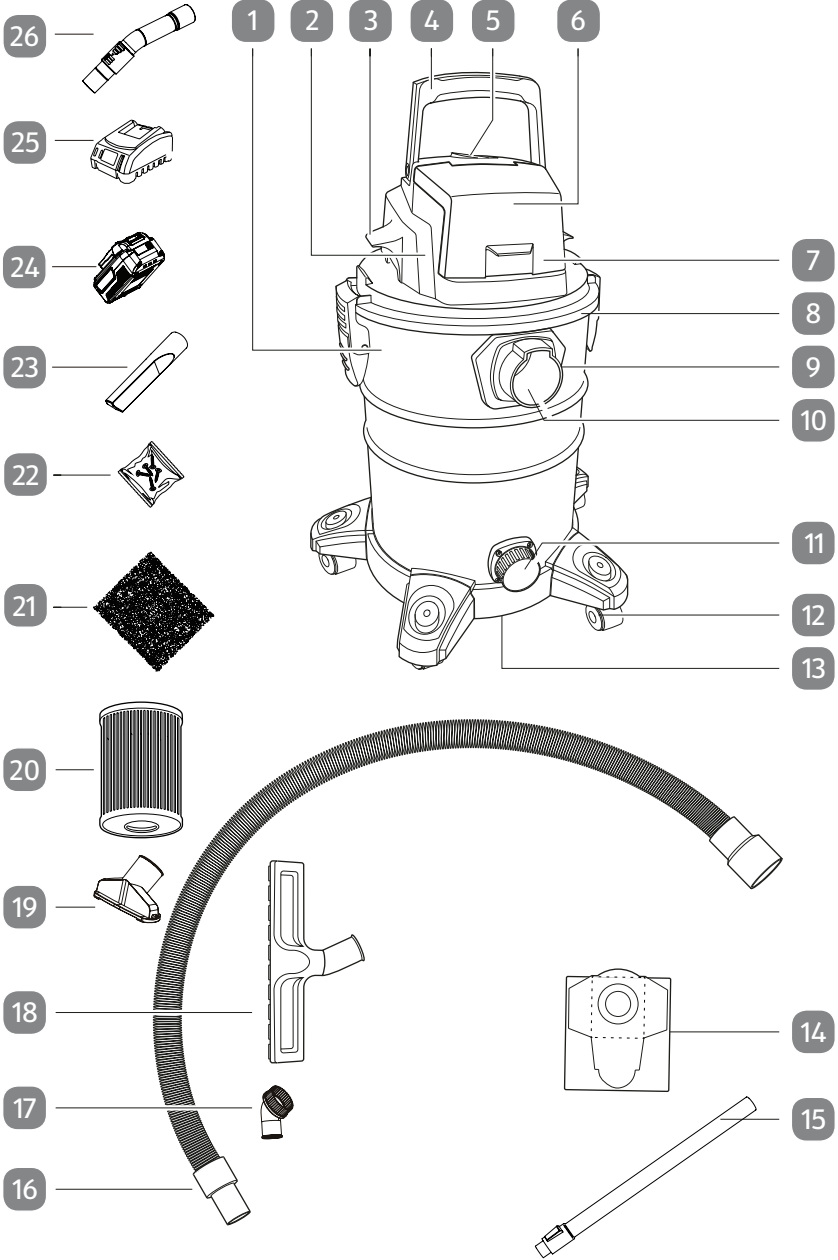

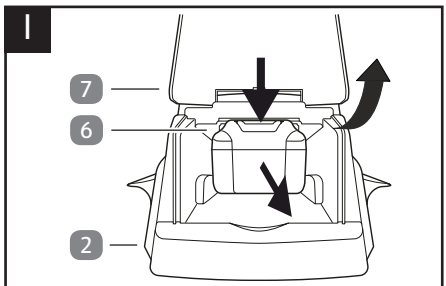
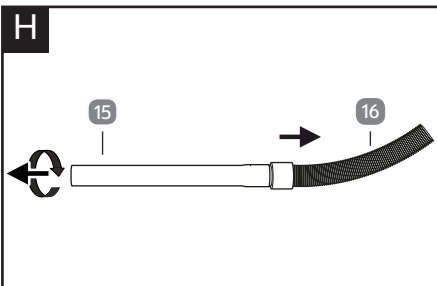
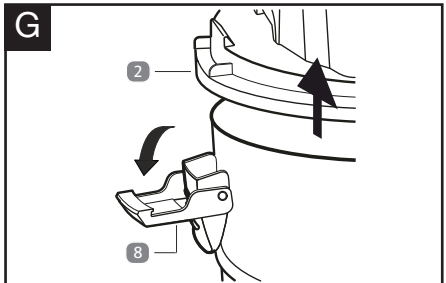
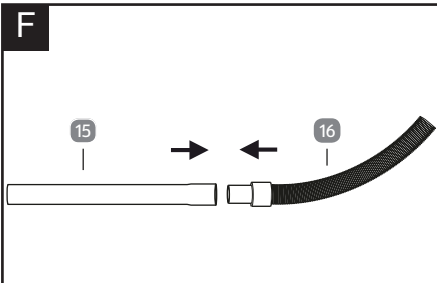
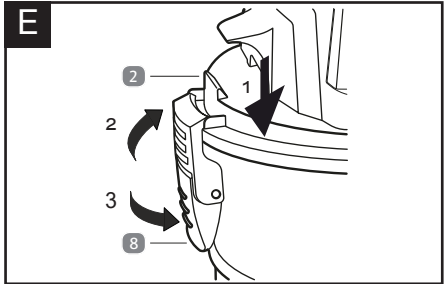
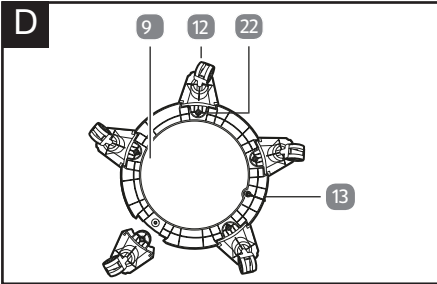
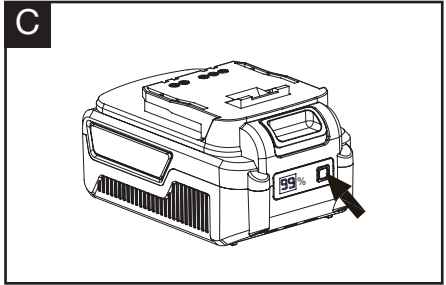
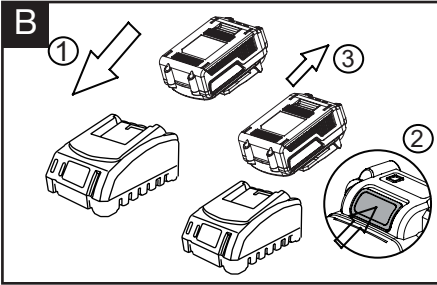

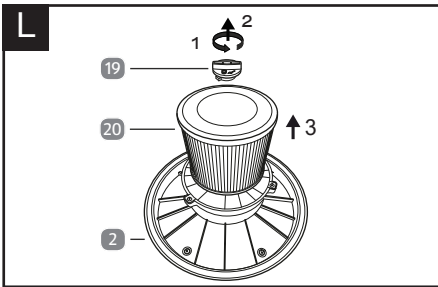
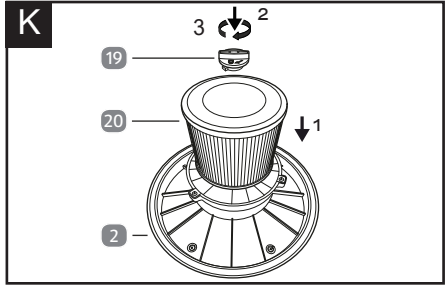
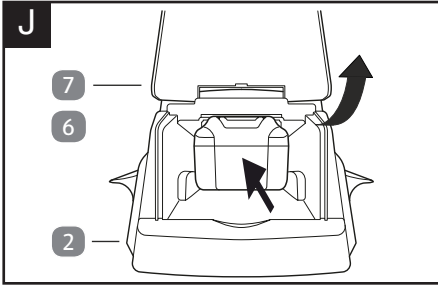

3

# **YARD FORCE**

## **LW CVC1 Original Instructions**

### **CONTENT**

Intended use	07
General safety warnings	07
Product safety warnings	14
Symbols	19
Technical data	23
Description of product	24
Operation	25
Maintenance and storage	29
Troubleshooting	31
Declaration of conformity	32

## INTENDED USE

The device is intended for wet&dry vacuuming at home, e.g. in the household, hobby room, car or garage using the appropriate filter.

It is intended exclusively for private use and not suitable for commercial use. Use the device only as described in these operating instructions. Any other use is considered improper and can lead to property damage or even personal injury. The device is not a children's toy.

The manufacturer or dealer assumes no liability for damage caused by improper or incorrect use.

Do not suck in any hot, burning, glowing, explosive or hazardous substances.

## GENERAL SAFETY WARNINGS

### WARNING

These operating instructions belong to this 20 V Li-Ion cordless wet and dry vacuum cleaner (hereinafter also referred to as "device"). It contains important information on commissioning and operation.

Read the operating instructions carefully, especially the safety instructions, before using the device. Failure to follow these operating instructions can result in serious injury or damage to the device.

The operating instructions are based on the standards and rules applicable in the European Union. When abroad, also observe country-specific guidelines and laws.

Keep the operating instructions for future reference. If you pass the device on to third parties, be sure to include these operating instructions.

## GENERAL SAFETY WARNINGS

### General safety information

1. Before commissioning, fully assemble the device in accordance with these instructions.
2. Only use spare parts and accessories that are supplied or recommended by the manufacturer. If third-party parts are used, all guarantee claims are immediately void.
3. Only have repairs carried out at customer service centers authorized by the manufacturer.

### Safety instructions

1. Children from 8 years of age and above as well as people with reduced physical, sensory or mental capabilities or a lack of experience and knowledge may only use the device if they are supervised or have been instructed in the safe use of the device and understand the resulting dangers.
2. Do not leave the device unattended during operation.
3. Only allow others access to the device after they have read the instructions in full and understood them appropriately or have been instructed about its intended use and the associated dangers.
4. Never allow people with reduced physical, sensory or mental capabilities (e.g. children or drunk people) or a lack of experience and knowledge (e.g. children) near the device unsupervised.
5. Do not leave cleaning and user maintenance unsupervised by children.
6. Children are not allowed to play with the device or with the connection cable.



## GENERAL SAFETY WARNINGS

### Safety instructions for cordless tools

1. Only charge the batteries with chargers recommended by the manufacturer. A charger designed for one type of battery may present a fire hazard if used with other batteries.
2. When the battery is not in use, keep it away from paper clips, coins, keys, nails, screws, or other small metal objects that could cause the contacts to be bridged. A short circuit between the battery contacts can result in burns or fire.
3. If used incorrectly, liquid can leak out of the battery. Avoid contact with it. In the event of accidental contact with water, rinse. If the liquid gets into your eyes, get additional medical help. Leaking battery fluid can cause skin irritation or burns.
4. Do not use a damaged or modified battery. Damaged or modified batteries can behave unpredictably and lead to fire, explosion or risk of injury.
5. Do not expose a battery to fire or high temperatures. Fire or temperatures above 45 ° C can cause an explosion.
6. Follow all charging instructions and never charge the rechargeable battery or the cordless device outside of the temperature range specified in the operating instructions. Incorrect charging or charging outside the permitted temperature range can destroy the battery and increase the risk of fire.

## GENERAL SAFETY WARNINGS

### **Safety instructions of wet&dry vacuum cleaner**

1. People and animals must not be vacuumed with the device.
2. Never point the suction hose and nozzles at your own body or other people, especially not at your eyes or ears, during operation.
3. When working, make sure that the nozzles and suction tube are not at head height.
4. Do not work without a filter. The device could be damaged.

### Safety symbols

The purpose of safety symbols is to attract your attention to possible dangers. The safety symbols and the explanations with them require your careful attention and full understanding. The symbol warnings do not, by themselves, eliminate any danger. The instructions and warnings they give are no substitutes for proper accident prevention measures.

**WARNING:** Be sure to read and understand all safety instructions in this operator's manual, including all safety alert symbols such as "**DANGER**," "**WARNING**," and "**CAUTION**" before using this tool. Failure to follow all instructions listed below may result in electric shock, fire and/or serious personal injury.

**SAFETY ALERT SYMBOL:** Indicates **DANGER**, **WARNING**, or **CAUTION**. May be used in conjunction with other symbols or pictographs.

### Symbol meaning

This page depicts and describes safety symbols that may appear on this product. Read, understand and follow all instructions on the machine before attempting to assemble and operate.

## SYMBOLS



Read the instructions for use before use!



WEEE symbol. Waste electrical products should not be disposed of with household waste. Please recycle where facilities exist. Check with your Local Authority or local store for recycling advice.



The product complies with the applicable European directives and an evaluation method of conformity for these directives was done.



A product placed on the United Kingdom market meets the UKCA Marking requirements

**IPX4** Degree of protection against ingress of water.

## SYMBOLS

### Warning symbols on the battery pack



To reduce the risk of injury, user must read the instruction manual carefully.



Do not throw into water.



Do not throw into fire.



Do not subject the battery to strong sunlight over long periods of time. Do not leave on a heater (max.45°C).



Li-Ion

Batteries contain Li-ion. Do not dispose of waste batteries in domestic waste. Contact local authority to find out how to dispose of batteries.



WEEE symbol. Waste electrical products should not be disposed of with household waste. Please recycle where facilities exist. Check with your Local Authority or local store for recycling advice.

## SYMBOLS

### Warning symbols on the charger



To reduce the risk of injury, user must read the instruction manual carefully.



The charger is for indoor use only.



Double insulation



WEEE symbol. Waste electrical products should not be disposed of with household waste. Please recycle where facilities exist. Check with your Local Authority or local store for recycling advice.



The product complies with the applicable European directives and an evaluation method of conformity for these directives was done.

T3.15A



Protective 3.15 A limited



A product placed on the United Kingdom market meets the UKCA Marking requirements

## TECHNICAL DATA

Model		LW CVC1
Mains voltage		20 V $\equiv$
Rated power		200 W
Protection class		IPX4
Suction power		9 kPa
Tank volume		20 l
Working time on one battery charge		20 min
Sound pressure level: $L_{pA}$		75.1 dB(A) K=3 dB(A)
Sound power level: $L_{wA}$		85.1 dB(A) K=3 dB(A)
Weight:		5 kg
Battery pack model		B0P-SP06-20ZL
Capacity		18V(Max.20) $\equiv$ 4.0Ah
Charger model		VDE: B0Q-SP06-20ZA BS: B0Q-SP06-20ZB
Input		220–240 V~, 50/60 Hz
Output:		20 V $\equiv$ , 2,4 A

The vibration emission level stated in this instruction manual has been measured in accordance with a standardized test given in EN 60745; it may be used to vibration when using the tool for the applications mentioned.

- using the tool for different applications, or with different or poorly maintained accessories, may significantly increase the exposure level
- the times when the tool is switched off or when it is running but not actually doing the job, may significantly reduce the exposure level.

Protect yourself against the effects of vibration by maintaining the tool and its accessories, keeping your hands warm, and organizing your work patterns.

## DESCRIPTION OF PRODUCT

### Parts description (Fig. A)

1. Wet&dry vacuum cleaner
2. Motor head
3. Motor head handle left / right
4. Carry handle
5. ON / OFF switch
6. Battery pack tank
7. Battery pack tank flap
8. Closing flap left / right
9. Stainless steel tank
10. Hose connection
11. Drain screw
12. Swivel castors (5x)
13. Anti static chain (not shown)
14. Dust bags
15. Suction pipe
16. Suction hose
17. Dust brush
18. Wide nozzle with rubber lip and brush
19. Utility nozzle
20. HEPA filter cartridge
21. Foam filter
22. Screws for swivel castors (8x)
23. Crevice nozzle
24. Battery pack
25. charger
26. Air regulation handle



## OPERATION

### Charging the battery pack

**NOTE:** Remove the battery pack from the charger after it has been fully charged.

**NOTE:** Battery should be fully charged before first use.

**NOTE:** Make sure the mains voltage is the same as rating label which is located on the charger.

1. Connect the charger to a power supply. Red LED will light up.
2. To insert the battery pack into the charger, align the raised ribs of the battery pack with the grooves of the charger then push it in. **(Fig. B)**
3. The red LED light of the charger will light up and then the green light flashes during normal charging.
4. After charging is complete, the charger light will turn to a solid green light.
5. Once the battery is fully charged, depress the battery release button and then remove the battery pack. **(Fig. B)**

### Power indicator (Fig. C)

This Li-Ion battery pack is equipped with a power indicator which is used to show the battery pack's remaining charge. Press the power indicator button to check battery charge as picture showed. The indicator will stay lit for approximately 4 seconds.

### To obtain the best life from the battery

1. Never allow the battery to completely discharge before recharging. The battery pack should be placed on the charger whenever the battery pack is noticeably running down or the tool no longer performs a task it previously performed.
2. Avoid conducting short charges. Make sure that the battery is fully charged each time by allowing the charger to complete its full charging cycle.
3. Avoid allowing loose items like screws or nails etc. to be stored with battery packs as these or similar items can short battery packs and cause a fire or explosion.
4. Always unplug the charger when not in use and store in a dry and secure place.
5. Avoid charging or storing your battery in temperatures below 5°C and above 45°C.
6. After use, allow the battery pack to cool down for approximately 30 minutes before attempting to recharge.

### Assembling the swivel castors (Fig. D)

1. Detach the motor head 2 (see chapter Detaching the motor head).
2. Remove all accessories from the stainless steel tank 9.
3. Place the stainless steel container 9 upside down on a flat surface.
4. Press the castors 12 one after the other into the five openings provided on the underside of the stainless steel container 9.
5. Tighten the castors 12 with one screw 22 each using the Phillips screwdriver.
6. Turn the stainless steel container over and place it on the castors 12.
7. Assemble the motor head 2 (see chapter Assembling the motor head).

## OPERATION

### Mount the motor head (Fig. E)

1. Align the motor head 2 with the locking flaps 8 and insert it into the stainless steel container 9.
2. Position the locking flaps 8 in the recesses on the motor head 2.
3. Close the flaps 8 by pressing down the lower parts.

### Connect the suction hose / accessories (Fig. F)

#### Connect the suction hose

Insert the suction hose 16 with the suction hose connector into the hose connection 10 until it audibly clicks into place.

#### Connect accessories

Insert the remaining end of the suction hose 16 into:

- The thick end of a suction tube 15 or 26
- into one of the nozzles 17, 18, 19, 23

Use as needed: no, one suction tube.

### Dismantling (Fig. G)

#### Detach the motor head

1. Fold up the lower part of the right flap.
2. Loosen the closing flap 8 by unhooking and folding down the upper part.
3. Repeat points 1 and 2 for the left side.
4. Use the motor head handles 3 to lift the motor head 2 off the stainless steel container 9.

### Remove the suction hose / accessories (Fig. H)

#### Remove the suction hose

Press the release button on the suction hose 16 and pull it off the hose connector 10.

#### Remove accessories

Hold the parts to be separated in one hand at a time.

Pull the pieces apart.

By twisting the parts, you can pull them apart more easily. Repeat points 1 and 2 for all parts to be removed.

### Remove / insert battery

#### Remove the battery (Fig. I)

1. Open the battery flap 7 on the motor head 2.
2. Press and hold the battery release button.
3. Pull the battery out of the battery holder 6

If the battery does not pull out easily, the release button was not pressed firmly enough. Press the release button more firmly.

4. Close the battery flap 7 on the motor head 2.

## OPERATION

### Insert the battery (Fig. J)

1. Open the battery flap 7 on the motor head 2.
2. Slide the battery into the battery holder 6.
3. Check that the battery is firmly seated.
4. Close the battery flap 7 on the motor head 2.

### Filter

#### Usage

- For coarse debris and demolition waste, use the HEPA filter cartridge 20 only.
- For vacuuming water, sludge, or soaked debris, use the foam filter 21.
- For fine dust and for general household use, install both HPEA filter 20 and dust bag 14.

### Insert the HEPA filter cartridge (Fig. K)

1. Dismantle the motor head 2 (see chapter Dismantling the motor head).
2. Place the motor head 2 upside down on a level surface. If a foam filter 21 is installed, remove it (see chapter Removing the foam filter)
3. Place the HEPA filter cartridge 20 on the filter holder.
4. Insert the filter locking screw through the HEPA filter cartridge 20 into the filter holder.
5. Tighten the filter locking screw clockwise.
6. Assemble the motor head 2 (see chapter Assembling the motor head).

### Remove the HEPA filter cartridge (Fig. L)

1. Dismantle the motor head 2 (see chapter Dismantling the motor head).
2. Place the motor head 2 upside down on a level surface.
3. Turn the filter locking screw 19 counterclockwise and pull it out.
4. Pull the HEPA filter cartridge 20 out of the filter holder.

### Insert foam filter

1. Detach the motor head 2 (see chapter Detaching the motor head).
2. Place the motor head 2 upside down on a level surface.  
If the HEPA filter cartridge 20 is installed, remove it (see chapter Removing the HEPA filter cartridge)
3. Carefully pull the open side of the foam filter 21 onto the filter holder. Do not pull too hard to prevent tearing.
4. Assemble the motor head 2 (see chapter Assembling the motor head).

### Remove the foam filter

1. Detach the motor head 2 (see chapter Detaching the motor head).
2. Place the motor head 2 upside down on a level surface.
3. Carefully pull the foam filter 21 off the filter holder.

## OPERATION

### Insert fine dust bag

**Risk of injury!** Always use the fine dust bag 14 together with the HEPA filter cartridge 20. Dismantle the motor head 2 (see chapter Dismantling the motor head).

1. Place the motor head 2 upside down on a level surface.
2. Unfold the fine dust bag 14.
3. Pull the fine dust bag 14 by its cardboard handle over the inner part of the hose connector 10.
4. Make sure that the seal of the fine dust bag 14 is pulled tightly over the inner part of the hose connector 10.
5. Assemble the motor head 2 (see chapter Assembling the motor head).

### Remove the fine dust bag

1. Detach the motor head 2 (see chapter Detaching the motor head).
2. Place the motor head 2 upside down on a level surface.
3. Pull the fine dust bag 14 off the inner part of the hose connector 10 by its cardboard handle.
4. Remove the fine dust bag 14 from the stainless steel container 9.

## Operation

### WARNING!

Risk of fire and explosion!

Certain substances can form explosive mixtures or vapors when they are swirled with suction air.

- Do not pick up any flammable, flammable, explosive or corrosive gases, vapors, liquids or dusts.
- Do not vacuum up organic solvents (e.g. benzine paint thinner or acetone).
- Do not suck up acids and bases undiluted.
- Do not vacuum up burning materials (e.g. wood)
- Do not vacuum up any smoldering materials (e.g. cigarette butts or ashes).

### Risk of injury!

Before starting the device, unwind the suction hose 16 completely.

Do not use the vacuum cleaner without a filter!

### Turn on a device

Press the **ON / OFF** switch 5 in the "I" position.

### Switch off the device

Press the **ON / OFF** switch 5 in the "O" position.

## OPERATION

### Dry vacuuming

#### Risk of injury!

Do not use a wet or damp device for dry vacuuming!

1. Insert the HEPA filter cartridge 20 (see chapter Inserting the HEPA filter cartridge).
2. Connect the suction hose and the accessories (see chapter Connecting the suction hose / accessories) Floor suction: Connect suction tube 15 and the wide nozzle with rubber lip and brush 18. Suction at table height or in tight spaces: Do not connect a suction tube 15 or a suction tube 15 and the crevice nozzle 23. If necessary, use a fine dust bag 14 (see chapter Filters).
3. Hold the suction hose 16 tight.
4. Switch on the device (see chapter Switching on the device).
5. Vacuum the area to be cleaned.
6. Switch off the device (see chapter Switching off the device).

### Wet vacuuming

#### Risk of injury!

Switch off the device immediately if liquid or wet dirt emerges from the housing.

1. Insert the foam filter 21 (see chapter Inserting the foam filter). Floor suction: Connect suction tube 15 and the wide nozzle with rubber lip and brush 18. Suction at table height or in tight spaces: Do not connect a suction tube 15 or a suction tube 15 and the crevice nozzle 23.
2. Hold the suction hose 16 tight.
3. Switch on the device (see chapter Switching on the device).
4. Vacuum the area to be cleaned.
5. Switch off the device (see chapter Switching off the device).
6. Clean the device and the accessories (see chapter Cleaning after wet vacuuming).

### Blow function

1. Remove all filters from the device (see chapter Filters).
2. Connect the suction hose 16 with the suction hose connector in the hose connection of the motor head 2 until it audibly clicks into place. Connect suction tube 15 and / or the crevice nozzle 23 as required.
3. Hold the suction hose 16 tight.
4. Switch on the device (see chapter Switching on the device).
5. Blow off an area or objects.
6. Switch off the device (see chapter Switching off the device).
7. Connect the suction hose (see chapter Connecting the suction hose).

## MAINTENANCE AND STORAGE

### Cleaning and storage

#### WARNING!

#### Risk of damage!

- Do not spray the device with water.
- Always check the device for obvious faults and defects before use; have them repaired if necessary and defective parts replaced.

### Cleaning

#### Risk of damage!

Improper handling of the device can lead to damage the device.

- Do not use any aggressive cleaning agents, brushes with metal or nylon bristles, or sharp or metallic cleaning objects such as knives, hard spatulas and the like. These can damage the surfaces.

### Cleaning after dry vacuuming

- Remove the battery.
- Remove all accessories and the suction hose 16 (see chapter Removing the suction hose / accessories).
- Detach the motor head 2 (see chapter Detaching the motor head).
- Knock the dust out of the HEPA filter cartridge 20.
- Clean the HEPA filter cartridge 20 with a paint brush or a brush.
- If a fine dust bag is used, remove it (see chapter Removing the fine dust bag).
- Empty the stainless steel container 9.
- Clean the motor head 2, the stainless steel container 9, the accessories and the suction hose 16 with a slightly damp cloth.
- Insert a filter (see chapter Filters).
- Assemble the motor head 2 (see chapter Assembling the motor head).

### Cleaning after wet vacuuming

- Remove the battery.
- Remove all accessories and the suction hose 16 (see chapter Removing the suction hose / accessories).
- Dismantle the motor head 2 (see chapter Dismantling the motor head).
- Remove the foam filter 21.
- Clean the foam filter 21 with lukewarm water and soap.
- Position a collecting container of sufficient size under the drain screw.
- Open the drain screw 11.
- Empty the stainless steel container 9.
- Rinse the stainless steel container 9, the accessories and the suction hose 16 with a

## MAINTENANCE AND STORAGE

mild soapy solution.

- Clean the motor head 2 with a slightly damp cloth.
- Let all parts of the device and all accessories dry.
- Close the drain screw 11.
- Insert a filter (see chapter Filters).
- Assemble the motor head 2 (see chapter Assembling the motor head).

### Storage

- Remove the battery.
- Wrap the suction hose 16 around the stainless steel container 9.
- Insert the accessories in the accessory holder on the motor head 2.
- Keep the device in a clean, dry, frost-free place inaccessible to children.

### Transport

- Only transport the device in the normal position, avoid a tilted transport position.
- When transporting the device in vehicles, it must be secured in accordance with the applicable regulations (load securing).

## MAINTENANCE AND STORAGE



**WARNING:** Before performing any repair work, always ensure that the battery pack has been removed.



**WARNING:** Always wear heavy duty gloves when adjusting or cleaning, especially when handling sharp objects.

Fault/malfunction	Cause	Remedy
The extracted material is blown out again at the motor head.	Filter damaged	Replace the filter (see chapter Filters).
The engine does not run or it blocked during operation.	Power supply interrupted	Remove and charge the battery pack
	Battery empty or without function	Clean the air vents
	Worn carbon brushes	Contact customer service
	ON / OFF switch defective	
	Motor defekt	
Low or no suction power.	Suction hose, suction tube or accessories clogged	Clean the suction hose, the suction tube and the accessories (see chapter Cleaning).
	Incorrectly connected suction hose	Connect the suction hose correctly (see chapter Connecting the suction hose / accessories).
	Stainless steel tank does not fitted in place	Close the stainless steel tank (see chapter Mounting the motor head).
	Stainless steel tank is full	Empty the stainless steel tank (see chapter cleaning).
	Filter capacity exhausted	Clean or replace the filter (see chapter Filters).



## DECLARATION OF CONFORMITY

To the provisions of Council Directives

We

MEROTEC GmbH

Otto-Brenner-Str. 8, 47877 Willich, Germany

Declare that the product:

Description: 20V Cordless wet&dry vacuum cleaner

Model No. LW CVC1

Function: vacuuming at home

**Complies with the essential health and safety requirements of the following directives:**

Low Voltage Directive 2014/35/EU

Electromagnetic Compatibility Directive 2014/30/EU

EC Directive 2011/65/EU and its amendment Directive (EU) 2015/863 (RoHS)

**Standards and technical specification referred to:**

EN 60335-2-2:2010+A11:2012+A1:2013

EN 60335-1:2012+A11:2014+A13:2017+A1:2019+A14:2019+A2:2019+A15:2021

EN 62233:2008

EN 55014-1:2017

EN 55014-2:2015

Authorized Signatory

Date: 18.01.2022

Signature: 

Place: Willich

Name: Ronald Menken

General Manager

MEROTEC GmbH  
Otto-Brenner-Str. 8  
D-47877 Willich



## DECLARATION OF CONFORMITY

To the provisions of Council Directives

We  
**SUMEC UK**  
Unit A&B Escrick Business Park Escrick, York YO19 6FD  
United Kingdom

Declare that the product:

Description: 20V Cordless wet&dry vacuum cleaner

Model No. LW CVC1

Function: vacuuming at home

**Complies with the essential health and safety requirements of the following directives:**

Electrical Equipment (Safety) Regulations 2016

The Restriction of the Use of Certain Hazardous Substances in Electrical and Electronic Equipment Regulations 2012

**Standards and technical specification referred to:**

EN 60335-2-2:2010+A11:2012+A1:2013

EN 60335-1:2012+A11:2014+A13:2017+A1:2019+A14:2019+A2:2019+A15:2021

EN 62233:2008

EN 55014-1:2017

EN 55014-2:2015

Authorized Signatory

Date: 18.01.2022

Signature: \_\_\_\_\_

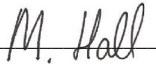

Place: York

Name: Mariana Hall

General Manager

SUMEC UK Co.,Ltd.

Unit A&B Escrick Business Park

Escrick, York YO19 6FD

United Kingdom

