



YARD FORCE®

FOR LIFE ON THE GO

LM C38

GB

20V CORDLESS ROLLER LAWN MOWER

Original Instructions

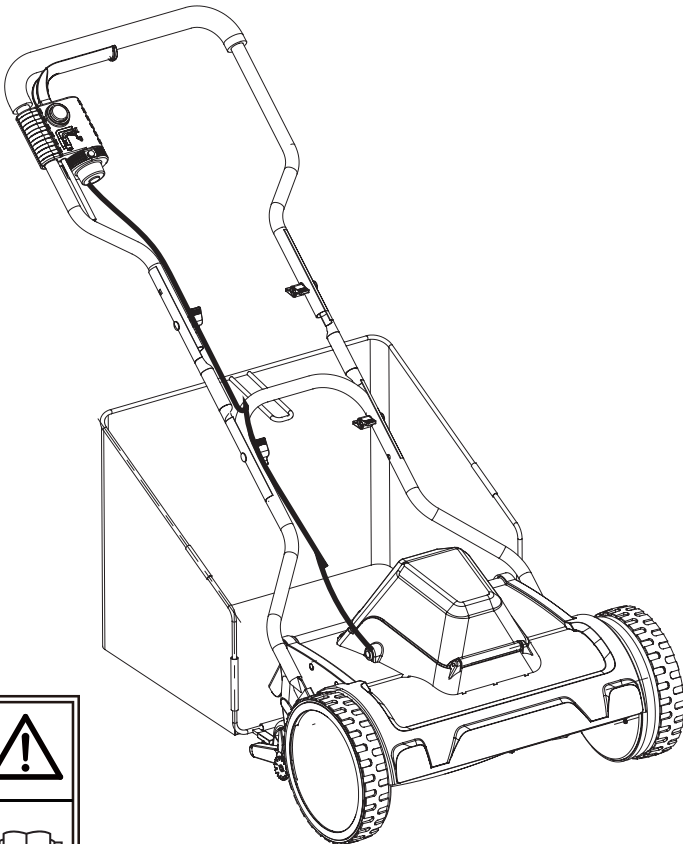



Read this manual carefully prior to assembling and operating the lawnmower. It is dangerous to operate this product without being familiar with these instructions. Keep this manual in a safe place and have it ready for future reference.

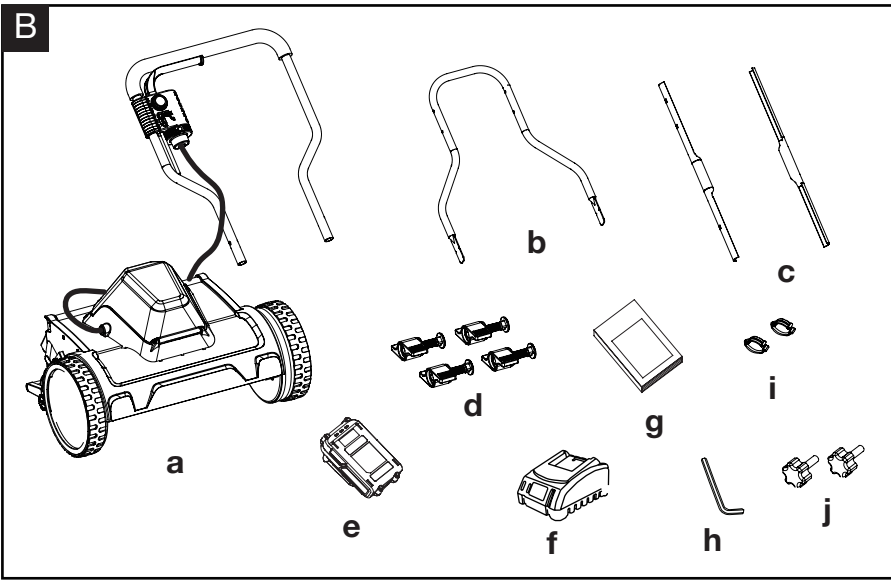
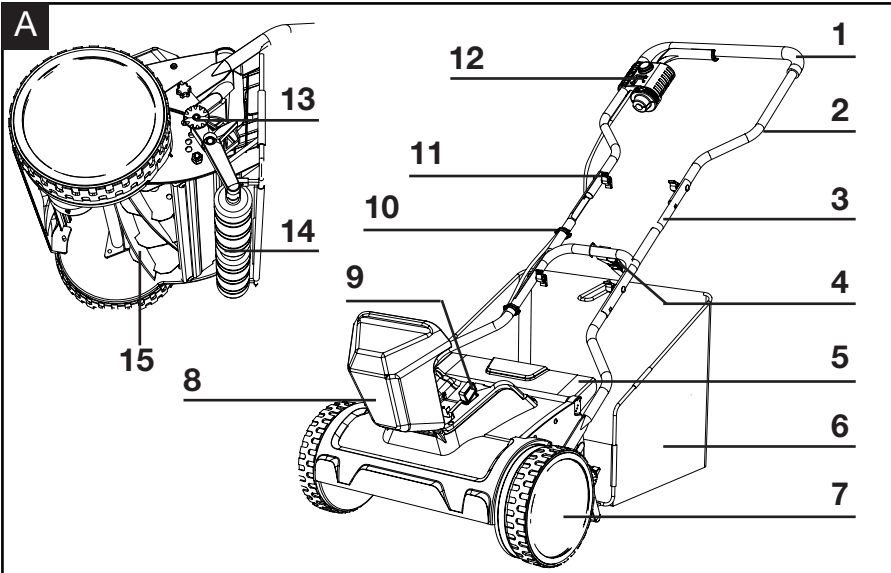

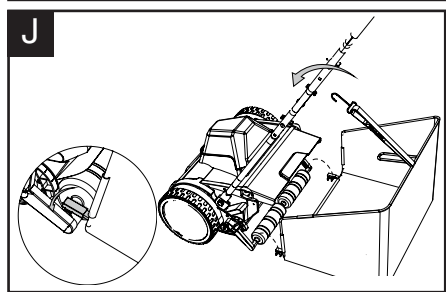
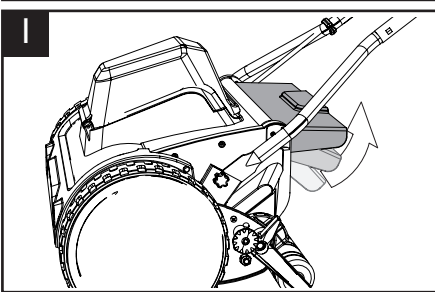
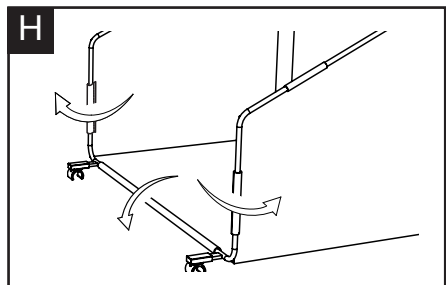
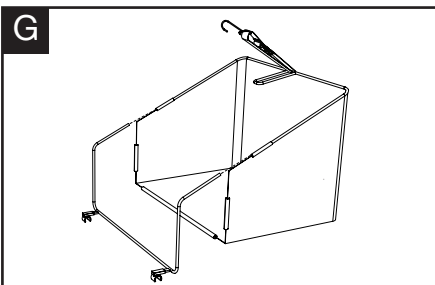
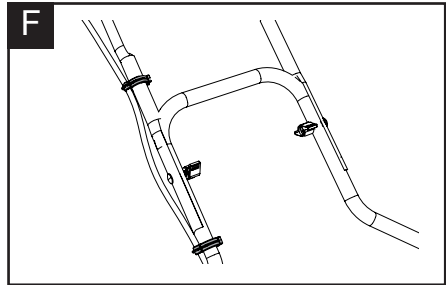
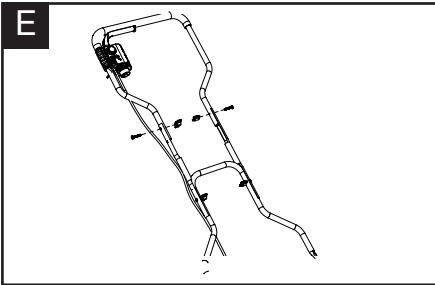
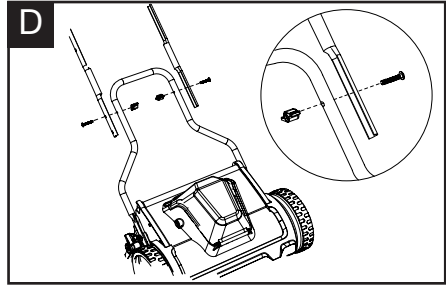
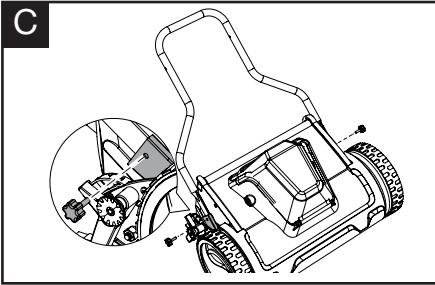

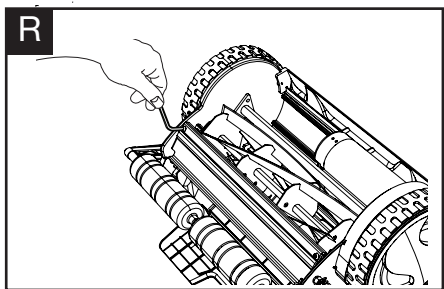
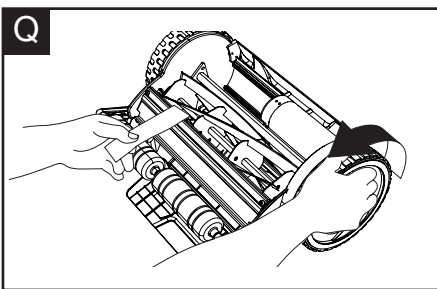
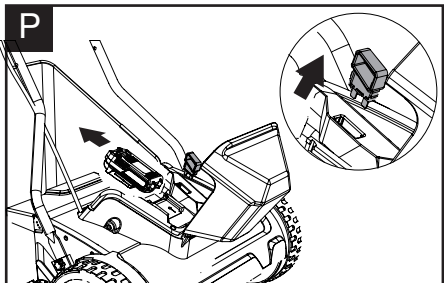
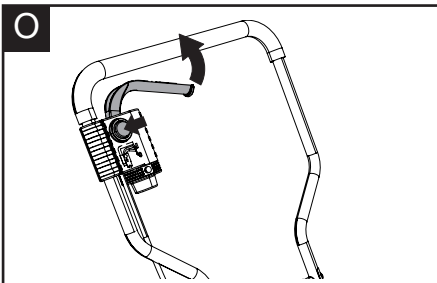
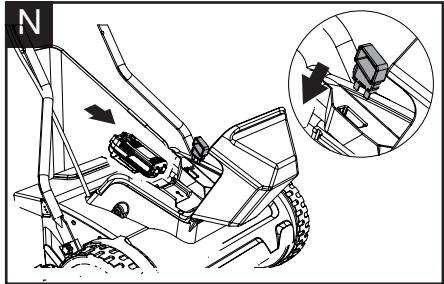
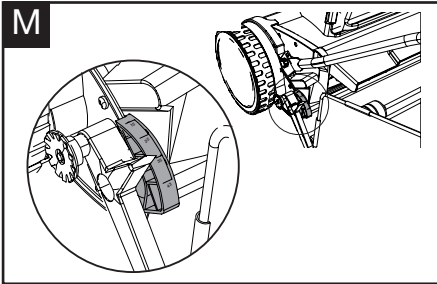
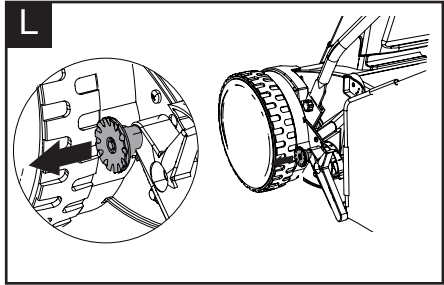
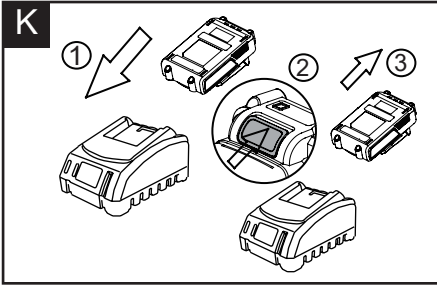

YARD FORCE

LM C38 Original Instructions

CONTENT

Intended use	07
General safety warnings	07
Product safety warnings	11
Symbols	16
Technical data	21
Description of product	22
Operation	23
Maintenance and storage	27
Troubleshooting	29
CE declaration	30

INTENDED USE

The powered cylinder mower is only intended for use outdoors.

The product is designed for domestic lawn mowing. Both wheels should touch the ground while mowing. It is a pedestrian-controlled walk-behind mower designed to be pushed by hand.

The product should never be operated with the wheels off the ground. It should not be ridden on. It should not be pulled while powered by the battery. It should not be used to cut anything other than domestic grass lawns.

Do not use the product for any other purpose.

GENERAL SAFETY WARNINGS

WARNING: The product is capable of amputating hands and feet, and throwing objects. Failure to observe all safety instructions could result in serious injury.

WARNING: When using the product, the safety rules must be followed. For your own safety and that of bystanders, please read these instructions before operating the product. Please keep the instructions safe for later use.

WARNING: The product should only be operated with the battery pack. When using battery- operated products, basic safety precautions should always be followed to reduce the risk

TRAINING

1. Read, understand, and follow all instructions on the product and in this manual before operating the product. Be thoroughly familiar with the controls and the proper use of the product. Know how to stop the product and disengage the controls quickly.
2. This appliance is not intended for use by persons (including children) with reduced physical, sensory or mental capabilities, or lack of experience and knowledge, unless they have been given supervision

GENERAL SAFETY WARNINGS

or instruction concerning use of the appliance by a person responsible for their safety. Children should be supervised to ensure that they do not play with the appliance.

3. Keep bystanders, children and pets 15 m away from the area of operation. Stop the product if anyone enters the area.
4. Keep in mind that the operator or user is responsible for accidents or hazards occurring to other people or their property.

PREPARATION

1. While operating the product, always wear adequate winter garments and non-skid safety footwear. Avoid wearing clothing that is loose fitting or that has hanging cords or ties; they can be caught in moving parts.
2. Thoroughly inspect the area where the product is to be used and remove all doormats, sleds, boards, wires, and other foreign objects.
3. Blades coming in contact with a “live” wire may make exposed metal parts of the product “live” and could give the operator an electric shock.
4. Before use, always visually inspect to ensure blades, blade bolts, and cutter assembly are not worn or damaged. Replace worn or damaged blades and bolts in sets to preserve balance. Bring the product to an authorised service centre to replace damaged or unreadable labels.

GENERAL SAFETY WARNINGS

5. Always wear safety glasses or eye shields during operation or while performing an adjustment or repair to protect eyes from foreign objects that may be thrown from the product.
6. Never attempt to make any adjustments while the product is running.
7. Secure long hair so it is above shoulder level to prevent entanglement in moving parts.
8. Ensure before each use that all controls and safety devices function correctly. Do not use the product if the “off” switch does not stop the product.

BATTERY TOOLS USE AND CARE

1. Recharge only with the charger specified by the manufacturer. A charger that is suitable for one type of battery pack may create a risk of fire when used with another battery pack.
2. Use power tools only with specifically designated battery packs. Use of any other battery packs may create a risk of injury and fire.
3. When battery pack is not in use, keep it away from other metal objects, like paper clips, coins, keys, nails, screws or other small metal objects, that can make a connection from one terminal to another. Shorting the battery terminals together may cause burns or a fire.
4. Under abusive conditions, liquid may be ejected from the battery; avoid contact. If contact accidentally occurs, flush with water. If liquid contacts eyes,

GENERAL SAFETY WARNINGS

additionally seek medical help. Liquid ejected from the battery may cause irritation or burns.

5. Do not use a battery pack or tool that is damaged or modified. Damaged or modified batteries may exhibit unpredictable behaviour resulting in fire, explosion or risk of injury.
6. Do not expose a battery pack or tool to fire or excessive temperature. Exposure to fire or temperature above 130°C may cause explosion.
7. Follow all charging instructions and do not charge the battery pack or tool outside the temperature range specified in the instructions. Charging improperly or at temperatures outside the specified range may damage the battery and increase the risk of fire.

CYLINDER MOWER SAFETY WARNINGS

1. Always use the product in the daylight or with good artificial light.
2. Do not operate the product on wet grass or in the rain.
3. Always be sure of your footing, and keep a firm hold on the handles. Walk; never run.
4. Mow across the face of slopes, never up and down.
5. Exercise extreme caution when changing direction on slopes.
6. Do not use the product near drop-offs, ditches, excessively steep slopes, or embankments. Poor footing could cause a slip-and-fall accident.
7. Use caution when reversing or pulling the product towards you.
8. Turn off the product and allow the blade to stop if the product has to be tilted for transportation when crossing surfaces other than grass, and when transporting the product to and from the work area.
9. Never use the product with defective guards or shields, or without safety devices, for example, deflectors and/ or grass collectors, in place.
10. Turn on the product carefully according to instructions and keep hands and feet away from blades. Do not put hands or feet near or under rotating parts.
11. Do not turn on the product when standing in front of the discharge opening.
12. Do not put hands or feet near or under rotating parts. Keep clear of the discharge opening at all times. Do not put any objects into openings.

PRODUCT SAFETY WARNINGS

13. Do not transport the product while the power source is running.
14. To reduce the risk of injury associated with contacting rotating parts, always turn off the product and remove the battery pack. Make sure all moving parts have come to a complete stop:
 - whenever leaving the product unattended (including disposal of grass clippings)
 - before checking, cleaning, or working on the product
 - before removing the grass catcher
 - after striking a foreign object; inspect the product for damage and make repairs as necessary before restarting and operating the product
 - If the product starts to vibrate abnormally (check immediately)
 - inspect for damage, particularly the blades
 - replace or repair any damaged parts
 - check for and tighten any loose parts
 - Remove the safety key and keep it key away from children when leaving the product unattended.
 - Remove the safety key when maintaining or transporting the product.

WARNING If the product is dropped, suffers heavy impact or begins to vibrate abnormally, immediately stop the product and inspect for damage or identify the cause of the vibration. Any damage should be properly repaired or replaced by an authorised service centre.

ADDITIONAL BATTERY SAFETY WARNINGS

WARNING

To reduce the risk of fire, personal injury, and product damage due to a short circuit, never immerse your tool, battery pack or in seawater, certain industrial chemicals, and bleach or bleach-containing products, etc., can cause a short circuit.

TRANSPORTATION AND STORAGE

1. Turn off the product and remove the battery pack. Allow the product to cool down before storing or transporting.
2. Clean all foreign material from the product. Store it in a cool dry and well-ventilated place that is inaccessible to children. Keep away from corrosive agents such as garden chemicals and de-icing salts. Do not store outdoors.
3. For transportation, secure the product against movement or falling to prevent injury to persons or damage to the product.

MAINTENANCE

WARNING Use only original manufacturer's replacement parts, accessories and attachments. Failure to do so can cause possible injury, can contribute to poor performance, and may void your warranty.

PRODUCT SAFETY WARNINGS

WARNING Servicing requires extreme care and knowledge and should be performed only by and repairs, have the product serviced by an authorised service centre only. When servicing, use only original replacement parts.

1. You may make adjustments and repairs described in this manual. For other repairs, have the product serviced by an authorised service centre only.
2. After each use, clean the product with a soft, dry cloth.
3. Check all nuts, bolts and screws at frequent intervals for proper tightness to ensure the product is in safe working condition. Any part that is damaged should be properly repaired or replaced by an authorised service centre.
4. Bring the product to an authorised service centre to replace damaged or unreadable labels.
5. Check the grass catcher frequently for wear or deterioration.
6. Be careful during adjustment of the product to prevent entrapment of the fingers between moving blades and fixed parts of the product.
7. When cleaning, repairing, or inspecting the product, make sure all moving parts have come to a complete stop. Remove the battery pack to prevent someone from accidentally starting the product.

RESIDUAL RISKS

Even when the product is used as prescribed, it is still impossible to completely eliminate certain residual risk factors. The following hazards may arise during use, and

PRODUCT SAFETY WARNINGS

the operator should pay special attention to avoid the following:

1. Injury caused by vibration. Always use the right tool for the job. Use designated handles and restrict working time and exposure.
2. Injury caused by noise. Exposure to noise can cause hearing injury. Wear ear protection and limit exposure.
3. Injury from contact with the blades.
4. injury caused by thrown objects.

RISK REDUCTION

It has been reported that vibrations from handheld tools may contribute to a condition called Raynaud's Syndrome. Symptoms may include tingling, numbness and blanching of to cold. Hereditary factors, exposure to cold and dampness, diet, smoking and work practices are all thought to contribute to the development of these symptoms. There are measures that can be taken by the operator to possibly reduce the effects of vibration:

- Keep your body warm in cold weather. When operating the product, wear gloves to keep the hands and wrists warm. It is reported that cold weather is a major factor contributing to Raynaud's Syndrome.
- After each period of operation, exercise to increase blood circulation.
- Take frequent work breaks. Limit the amount of exposure per day.

If you experience any of the symptoms of this condition, immediately discontinue use and see your physician.

Safety symbols

The purpose of safety symbols is to attract your attention to possible dangers. The safety symbols and the explanations with them require your careful attention and full understanding. The symbol warnings do not, by themselves, eliminate any danger. The instructions and warnings they give are no substitutes for proper accident prevention measures.

WARNING: Be sure to read and understand all safety instructions in this operator's manual, including all safety alert symbols such as "**DANGER**," "**WARNING**," and "**CAUTION**" before using this tool. Failure to follow all instructions listed below may result in electric shock, fire and/or serious personal injury.

SAFETY ALERT SYMBOL: Indicates **DANGER**, **WARNING**, or **CAUTION**. May be used in conjunction with other symbols or pictographs.

Symbol meaning

This page depicts and describes safety symbols that may appear on this product. Read, understand and follow all instructions on the machine before attempting to assemble and operate.

SYMBOLS



This symbol, before a safety comment, indicates a precaution, a warning or a danger. Ignoring this warning can lead to an accident for yourself or for others. To limit the risk of injury, fire, or electrocution always apply the recommendations indicated.

To reduce the risk of injury, user must read the instruction manual carefully.



Wear protective goggles.



Wear suitable protective gloves.



Wear ear protection



Wear a dust mask.



Wear foot protection



Protect against rain and wet.
Do not expose and operate the tool in rain.

SYMBOLS



Ensure that other people and pets remain at least 15m away from the line trimmer when it is in use.



Guaranteed sound power level value in 96 dB.



WEEE symbol. Waste electrical products should not be disposed of with household waste. Please recycle where facilities exist. Check with your Local Authority or local store for recycling advice.



The product complies with the applicable European directives and an evaluation method of conformity for these directives was done.



Rotating blades, keep hands and feet away from the opening while the machine is running.



Beware of sharp blades. Blades continue to rotate after the motor is switched off. Remove disabling device before performing any maintenance tasks.

SYMBOLS

Warning symbols on the battery pack



To reduce the risk of injury, user must read the instruction manual carefully.



Do not throw into water.



Do not throw to fire.



Do not subject the battery to strong sunlight over long periods of time. Do not leave on a heater (max.45°C).



Li-Ion

Batteries contain Li-ion. Do not dispose of waste batteries in domestic waste. Contact local authority to find out how to dispose of batteries.



WEEE symbol. Waste electrical products should not be disposed of with household waste. Please recycle where facilities exist. Check with your Local Authority or local store for recycling advice.

SYMBOLS

Warning symbols on the charger



To reduce the risk of injury, user must read the instruction manual carefully.



The charger is for indoor use only.



Double insulation



WEEE symbol. Waste electrical products should not be disposed of with household waste. Please recycle where facilities exist. Check with your Local Authority or local store for recycling advice.









The product complies with the applicable European directives and an evaluation method of conformity for these directives was done.

T 3.15A



Protective 3.15 A limited

TECHNICAL DATA

Model		LM C38
Mains voltage		20 V 
No load speed		1000 min ⁻¹
Cutting width		38 cm
Sound power level: L _{WA}		88.29 dB(A) K=1.73 dB(A)
Guaranteed sound power level L _{WA} (according to 2000/14/EC)		96 dB
Vibration front handle		2.6 m/s ² K=1.5 m/s ²
Weight (with battery pack): Weight (without battery pack):		14,2 kg 13,5 kg
Battery pack model		B0P-SP06-20ZL
Capacity		20 V  , 2.0 Ah
Charger model		B0Q-SP06-20ZA
Input		220–240 V~, 50/60 Hz 65 W
Output:		21 V  , 2.4 A
Protection class		II

The declared vibration total value has been measured in accordance with a standard test method and may be used for comparing one tool with another;

The declared vibration total value may also be used in a preliminary assessment of exposure.

NOTICE: The vibration emission during actual use of the power tool can differ from the declared value in which the tool is used. In order to protect the operator, user should wear gloves and ear protectors in the actual conditions of use.

DESCRIPTION OF PRODUCT

Parts description (Fig. A)

1. Soft grip
2. Upper handle frame
3. Middle handle bars
4. Lower handle frame
5. Ejector flap
6. Grass collection bag
7. Wheel
8. Battery compartment cover
9. Safety key
10. Cable clip
11. Upper handle knob
12. Safety lock button
13. Height adjustment knobs
14. Roller bar
15. Cylinder blade

Delivery contents (Fig. B)

Carefully unpack the appliance and check that it is complete. Dispose of the packaging material correctly.

- a. Roller mower
- b. Lower handle frame
- c. Middle handle bars
- d. Upper handle knob
- e. Battery pack
- f. Charger
- g. Manual
- h. Allen key
- i. cable clip
- j. bolt



WARNING: If any parts are damaged or missing, do not operate this tool until these parts are replaced. Failure to heed this warning could result in serious personal injury.



NOTE: Always recycle the packaging in accordance with local recycling guidelines.

ASSEMBLY

WARNING: Do not insert the battery and the safety key until assembly is complete. Failure to comply could result in accidental starting and serious personal injury.

WARNING: Before performing any maintenance, make sure the battery and the safety key are removed from the unit. Failure to heed this warning could result in serious personal injury.

WARNING! The product must be fully assembled before operation. Do not use a product that is only partially assembled or assembled with damaged parts.

NOTE: Before using the reel mower, follow these instructions to assemble the appliance.

Handle Assembly

1. Insert the ends of the lower handle frame into the sockets on both side of the mower base. Lock with the lower handle knobs provided. (Fig. C)
2. Fit the middle handle bars on both sides of the lower handle frame, aligning the holes. Secure with two sets of handle knobs and bolts. (Fig. D)
NOTE: Each middle handle bar has 2 holes on the top and the bottom. Adjust the handle assembly to the optimal position by aligning with the hole at the desired height.
3. Fit the upper handle frame on both the middle handle bars, as shown, aligning the holes. Secure with the remaining two sets of handle knob and bolt. (Fig. E)
4. Secure the cable with the two cable clips, as shown. (Fig. F)

Grass Collection Bag Assembly + Fitting

The grass collecting bag prevents grass clippings being thrown across your lawn as you mow.

1. Fit the grass collection bag support rod into the tube of the grass collection bag. (Fig. G)
2. Clip the protective leather profiles onto the support rod to secure the assembly (Fig. H).
3. Lift the ejector flap to the highest position, and assemble the grass collection bag onto the mower by hooking the sockets to both ends of the roller bar shaft. (Fig. I)
4. Hook the strap hook of the grass collection bag on the center bar on the lower handle frame. Adjust the strap to an appropriate height so that the grass collection bag does not rub against the ground while mowing or transporting the unit. (Fig. J)
5. The mower can be used without the grass collection bag. When the grass collection bag is not attached, adjust the ejector flap to a suitable position to shield flying grass clippings.

OPERATION

Charging the battery pack (Fig. K)

NOTE: Remove the battery pack from the charger after it has been fully charged.

NOTE: Battery should be fully charged before first use.

NOTE: Make sure the mains voltage is the same as rating label which is located on the charger.

1. Connect the charger to a power supply. Red LED will light up.
2. To insert the battery pack into the charger, align the raised ribs of the battery pack with the grooves of the charger then push it in.

Power indicator

This Li-Ion battery pack is equipped with a power indicator which is used to show the battery pack's remaining charge. Press the power indicator button to check battery charge as picture showed. The indicator will stay lit for approximately 4 seconds.

To obtain the best life from the battery

1. Never allow the battery to completely discharge before recharging. The battery pack should be placed on the charger whenever the battery pack is noticeably running down or the tool no longer performs a task it previously performed.
2. Avoid conducting short charges. Make sure that the battery is fully charged each time by allowing the charger to complete its full charging cycle.
3. Avoid allowing loose items like screws or nails etc. to be stored with battery packs as these or similar items can short battery packs and cause a fire or explosion.
4. Always unplug the charger when not in use and store in a dry and secure place.
5. Avoid charging or storing your battery in temperatures below 5°C and above 45°C.
6. After use, allow the battery pack to cool down for approximately 30 minutes before attempting to recharge.

Adjusting the Cutting Height

This cordless reel mower is equipped with a 4-position height adjustment system to tailor grass cutting heights from 15mm to 43mm. To change the cutting height of the grass, follow the instructions below.

WARNING! Before making these adjustments, remove the battery and the safety key from the lawn mower and wait until the rotating blades have come to a complete standstill.

ALWAYS FOLLOW ALL SAFETY PRECAUTIONS AND RECOMMENDATIONS LISTED PREVIOUSLY IN THIS MANUAL.

1. Power off the reel mower and remove the battery and the safety key.
2. To adjust the cutting height, pull out the height adjustment knobs on both sides of the reel mower frame and insert the knobs to the desired setting. (Fig. L)
3. To adjust the reel to the highest cutting position, place the adjustment knobs through the bottom hole located on the sides of the reel mower frame. To adjust the reel to the lowest cutting position, place the adjustment knobs through the top hole located on the sides of the frame. (Fig. M)
4. Other cutting heights are achieved by moving the adjustment knobs to the settings between the highest and lowest positions. Refer to the mark beside the height adjustment knobs when adjusting the cutting height.

OPERATION

Starting + Stopping

WARNING! Before switching on the reel mower, make sure that it is not in contact with any foreign objects. Keep your hands and feet a safe distance away from the rotating mower blades and the ejector opening. Failure to comply with these warnings can result in severe personal injury.

IMPORTANT: Do not start the reel mower in tall grass.

1. Make sure the unit's On/Off switch lever is not squeezed on. Insert the battery and the safety key in their slots. Close the battery compartment cover. (Fig. N)
2. To start the machine, press and hold the safety lock button, then pull the On/Off switch lever toward you. Once the machine powers on, release the safety lock button and proceed with operation. (Fig. O)
3. To stop the mower, release the On/Off switch lever. and take out the battery pack. (Fig. P)

WARNING! The mower blade will continue to rotate for a brief period after the unit has been switched off. Do not tilt or carry the unit while the motor is still running and do not touch the blade while it is still rotating. Failure to comply could result in severe personal injury.

Mowing Tips

WARNING! Inspect the area prior to mowing and remove all the stones, sticks, wires and other foreign objects that could be picked up and thrown by the rotating blade. Failure to comply not only will damage the mower blade, but can also lead to serious personal injury.

- Be sure to check the blades periodically for signs of wear and replace them at least once per year, as described in the maintenance section.

NOTE: Sharp blades will greatly enhance the performance of the reel mower, especially when cutting tall grass.

- When cutting thick grass, reduce your walking speed in order to allow for a more effective cut and a proper discharge of the clippings. For a healthy lawn, always cut off one-third or less from the total length of the grass. The average lawn should be approximately 3.8 cm to 5 cm in long during cool months, and more than 5 cm long during hot months. If there is growth, the lawn should be cut in the fall.
- The lawn will look better if it is always cut to the same height and in alternate directions.
- When crossing any gravelled surfaces, release the On/ Off switch lever to turn off the mower. The stones can be picked up and thrown by the rotating blade.
- Set the mower to the highest cutting height when mowing on uneven ground or in tall weeds.

WARNING! If you strike a foreign object, stop the motor and remove the battery. Thoroughly inspect the mower and repair any damage before resuming work.

- Switch off the motor before emptying the grass collection bag. Always ensure that a safe distance (provided by the length of the long handles) is maintained between the user and the mower housing. Be especially careful when mowing and changing direction on slopes and inclines.

OPERATION

- Maintain a solid footing and wear sturdy, non-slip footwear and long trousers. Always mow across an incline (not up and down).
- Use special caution when backing up and pulling the reel mower towards you as such maneuvering of the machine poses a tripping hazard.
- For effective mulching, do not cut wet grass; it tends to stick to the underside of the deck, preventing the proper mulching of grass clippings. The best time to mow grass is in the late afternoon, when the grass is dry and the newly cut area will not be exposed to direct sunlight.
- For the best mulching performance, set the cutting height to remove approximately one third of the grass length, ideally no more than 4 cm in. at one time. If the grass is overgrown, it may be necessary to increase the cut height to make it easier to mow and to prevent overloading the motor. Slow your cutting pace in tall or thick grass conditions. For mulching extremely thick or tall grass, it is advisable to first cut at a high cut-height setting, and then re-cut to the final cut height. Otherwise, make narrower cuts and mow slowly. **ALWAYS MAKE SURE THAT THE BLADE IS SHARP.**

MAINTENANCE AND STORAGE

WARNING! Before cleaning, repairing, or inspecting the reel mower, stop the machine, disconnect the safety key and the battery. Verify that all moving parts have come to a complete stop.

General

- Always keep the reel mower clean and free of grass, dirt, or other debris.
- Keep the handles dry, clean, and free of oil and grease.
- After each cutting session, remove accumulated grass clippings and debris using either a dry cloth or hand brush. You may also clean the equipment with a damp cloth. Do not use cleaning agents or harsh solvents as they may damage the equipment's plastic components. Make sure that no water penetrates the equipment's interior as intake of water can destroy the switch mechanism and the electric motor.
- Do not clean the reel mower with running water, particularly with high-pressure water.
- Check all nuts, bolts, and screws for proper tightness before each use.
- Frequently inspect the grass collection bag for signs of wear and replace immediately with a genuine Yard force part if damage is found.
- Replace excessively worn or damaged parts immediately.

Lubrication

All of the bearings in this product are lubricated with a sufficient amount of high grade lubricants for the life of the unit under normal operation conditions. Therefore, no further lubrication of the bearings is needed.

Ensuring a clean cut

WARNING! The steel blades are extremely sharp.

To avoid injury, do not touch the blades while making adjustments. Misalignment of the blades can occur, which often results from blades that are either too loose or too tight. This can cause an uneven cut or difficulty pushing the mower.

1. Place the mower on a flat surface. Remove the handles and the grass collection bag. Turn the mower upside down to expose the blades and the cutting bar.
2. Insert a piece of paper between the steel blades and the cutting bar, then slowly turn the wheel by hand. (Fig. Q)
3. All the blades should slice the paper evenly along the entire length of the cutting bar while the wheel is turned smoothly. Repeat this testing on the other side of the mower.
4. If the mower cuts the paper intermittently, use the hex key wrench provided to tighten the adjustment bolt closest to where the intermittent cut was observed. Tighten the bolt on the appropriate end of the cutting bar by turning it clockwise approximately 1/8th of a turn until the steel blade contacts the cutting bar. (Fig. R)
5. If it becomes too difficult to move the wheel by hand while adjusting the reel blades, back off the adjustment bolt slightly by turning it counterclockwise. Test again with a new piece of paper to verify proper cutting action.
6. Make the same adjustment at the other end of the cutting bar.

WARNING! Both adjustment bolts should have tension on final adjustment. Do not overtighten the adjustment bolts as this could damage the blades.

MAINTENANCE AND STORAGE

Cleaning and Storage

1. Clean the exterior of the machine thoroughly using a soft brush and cloth before storing. Do not use water, solvents, or polishes.
2. Turn the mower on its side to clean the blade area.
WARNING! Do not place your hands inside or near the cutting area. If grass cuttings are compacted in the blade area, remove them using a wood or plastic cleaning tool appropriate for blade cleaning.
3. Store the mower in a dry place. Do not place other objects on top of the mower during storage.

Maintenance Tips

Reel mowers are relatively low maintenance. For consistent cutting, follow the below instructions:

- Always keep the cutting blades properly adjusted. Refer to the instruction manual for further directions.
- Regularly clean and lubricate cutting edges with light spray oil.

IMPORTANT! Reel mowers have difficulty cutting tall weeds, such as dandelions, and will often bend, rather than cut, such weeds. Cut often to prevent this.

Recycling + Disposal

The product comes in a package that protects it against damage during shipping. Keep the package until you are sure that all parts have been delivered and the product is functioning properly. Recycle the package afterwards or keep it for long-term storage.

WEEE symbol. Waste electrical products should not be disposed of with household waste. Please recycle where facilities exist. Check with your local authority or local store for recycling regulations.

WARNING! To reduce the risk of injury or explosion, never burn or incinerate a battery pack even if it is damaged, dead or completely discharged. When burned, toxic fumes and materials are emitted into the surrounding atmosphere.

1. Batteries vary according to device. Consult your manual for specific information.
2. Install only new batteries of the same type in your product (where applicable).
3. Failure to insert the battery in the correct polarity, as indicated in the battery compartment or manual, may shorten the life of the batteries or cause batteries to leak.
4. Do not mix old and new batteries.
5. Do not mix Alkaline, Standard (Carbon-Zinc) or Rechargeable (Nickel Cadmium, Nickel Metal Hydride, or Lithium-Ion) batteries.
6. Do not dispose of batteries in fire.
7. Batteries should be recycled or disposed of as per state and local guidelines.

TROUBLESHOOTING

Fault	Possible Cause	Remedy
Mower fails to start	The safety key is not inserted	Insert the safety key
	The battery is low	Charge the battery
	The battery is not inserted securely	Attach the battery pack to the mower; press it until you hear a click
	The motor/blade control is disengaged	Press safety lock button first, then the On/Off switch lever
	The mower deck is clogged with grass or debris	Clean the mower deck. Make sure the blade is free to move
	The grass is too tall	Set the mower to a high cutting height. Lift the front wheels slightly by pressing down on the handle bar.
Mower stops while mowing	The battery is flat	Charge the battery
	The grass is too tall	Reset the cutting height
	The mower deck is clogged with grass or debris	Clean the mower deck. Make sure the blade is free to move
	The battery or the mower circuitry is too hot	Cool down the battery and the machine
The mower cannot cut grass evenly	The blade is not sharp enough	Sharpen or replace the blade
The mower is difficult to push	The grass is too tall to cut	Adjust cutting height higher
	The blade or the mower rear is dragged by heavy grass	Tighten the adjusting bolts
	Too much tolerance between the steel blades and the cylinder	
The mower is vibrating at high speed	The motor shaft is bent	Stop the motor, remove the battery, and inspect the damage. Contact with a qualified repair person
	The blade is unbalanced	Balance the blade by grinding each cutting edge equally or replace a new one
	The adjusting bolts are loose	Tighten the adjusting bolts

CE DECLARATION

To the provisions of Council Directives

We
MEROTEC GmbH,
Otto-Brenner-Straße 8,
47877 Willich/ Deutschland

Declare that the product:
Description: 20V Cordless roller lawn mower
Model No. LM C38
Function: cutting Grass

Complies with the essential health and safety requirements of the following directives:

Machinery Directive 2006/42/EC
Electromagnetic Compatibility Directive 2014/30/EU
EC Directive 2011/65/EU and its amendment Directive (EU) 2015/863 (RoHS)
Outdoor Noise Directive 2000/14/EC & 2005/88/EC
Measured Sound Power Level: Impact knife: $L_{wA} = 88.29 \text{ dB(A)}$ $K=1.73 \text{ dB(A)}$
Guaranteed Sound Power Level: 96 dB(A).

Standards and technical specification referred to:

EN 60335-1:2012+A11:2014+A13:2017+A1:2019+A14:2019+A2:2019
EN 60335-2-77:2010
EN 55014-2:2015
EN 55014-1:2017
EN 62233:2008
EN 50581:2012

Authorized Signatory
Date: 23.01.2022

Signature: 
Place: Willich
Name: Roland Menken
General Manager

MEROTEC GmbH,
Otto-Brenner-Straße 8,
47877 Willich/ Deutschland

